

NO.	DATE	DESCRIPTION
07/06/15	100% CD COMPLIANCE	

100% CD DOCUMENTS
 24 OCTOBER 2014

Louis Armstrong House Museum Education Center

34-49 107th Street
 Corona, New York 11368
 Block 1749, Lot 66

Architects:
Capes Jefferson Architects PC
 37-18 Northern Boulevard, Suite 319
 Long Island City, New York 11101
 p: 212.779.9772 f: 212.202.6545

Structural Engineers:
Severud Associates
 469 Seventh Avenue, Suite 900
 New York, New York 10018
 p: 212.986.3700 f: 212.687.6467

MEP and Security Engineers:
WSP Flack+Kurtz
 512 Seventh Avenue
 New York, New York 10018
 p: 212.532.9600 f: 212.689.7489

Lighting Consultant:
Arup
 77 Water Street
 New York, New York 10005
 p: 212.696.0000

Theatrical Lighting Consultant:
Fisher Dachs Associates
 22 West 18th Street
 New York, NY 10011
 p: 212.691.3020 f: 212.633.1644

Audiovisual Consultant:
Boyce Nemeo Designs
 3 Station Place
 P.O. Box 566
 Norwalk, CT 06858
 p: 860.542.5937 f: 860.542.5614

Acoustical Consultant:
Creative Acoustics
 5 Inwood Lane
 Westport, CT 06880
 p: 203.226.8949 f: 203.246.2440

Sustainable Design Consultant:
Steven Winter Associates
 60 Washington Street, 6th Floor
 Norwalk, Connecticut 06854
 p: 203.857.0500 f: 203.852.0741

Sitework Consultant:
Craig Richmond Landscape Architecture
 2 Green Street, Suite 2W
 Huntington, NY 11743
 p: 616.332.3568

Cost Consultant:
Berk&Schoen Consultants
 299 Broadway, Suite 1102
 New York, New York 10007
 p: 212.243.2434 f: 212.691.2409

STAMP:

Bitmap3542355403.jpg

DOB STAMP:

DOB BSCAN:

KEY

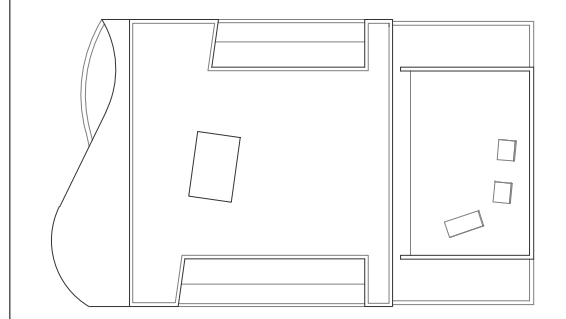

Drawing Title:
 FIRST FLOOR PLAN

Scale:
 AS NOTED
 Date:
 24 OCTOBER 2014

Drawing Number:
 A-121.00

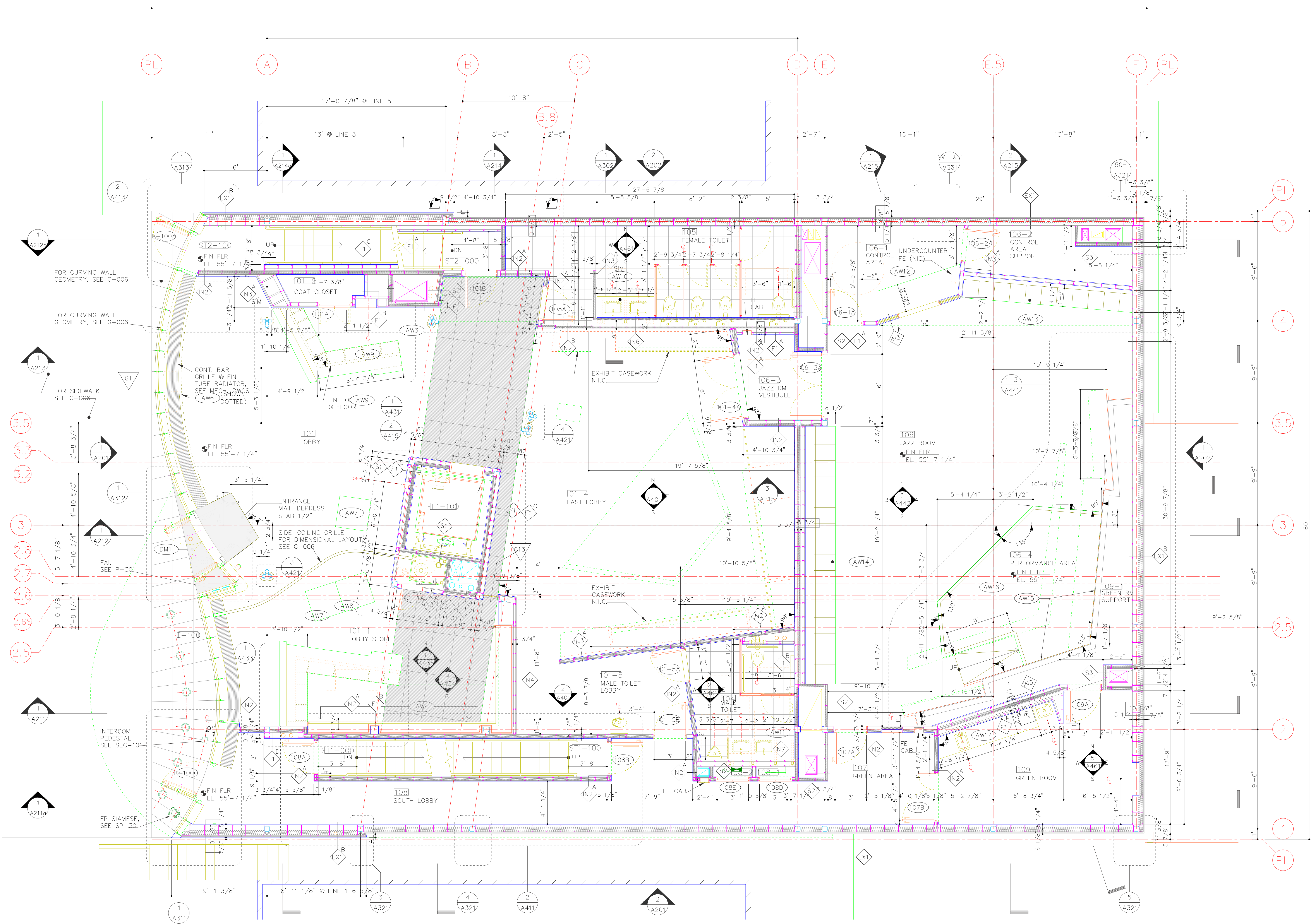

1ST FLOOR ROOM KEY

RM. #	ROOM NAME
E-100	ENTRY
101	LOBBY
101-1	LOBBY STORE
101-2	COAT CLOSET
101-3	FEMALE TOILET LOBBY
101-4	EAST LOBBY
101-5	MALE TOILET LOBBY
101-6	GATE POCKET
104	MALE PUBLIC TOILET
105	FEMALE PUBLIC TOILET
106	JAZZ ROOM
106-1	CONTROL AREA
106-2	CONTROL AREA SUPPORT
106-3	JAZZ ROOM VESTIBULE
106-4	JAZZ ROOM PLATFORM
107	GREEN AREA
108	SOUTH LOBBY
108-1	ELECTRICAL CLOSET
108-2	SPRINKLER CLOSET
109	GREEN ROOM
109-1	GREEN ROOM SUPPORT
ST1-10	STAIR 1
ST2-10	STAIR 2
ELL-10	ELEVATOR

- NOTES**
- FOR SYMBOLS & ABBREVIATIONS, SEE G-001
 - FOR PARTITION TYPES, SEE A-501 & A-502
 - FOR FINISH SCHEDULE & FIREPROOFING SCHEDULE, SEE A-503
 - FOR DOORS & HARDWARE, SEE A-404
 - FOR REFLECTED CEILING PLAN, SEE A-132
 - FOR EDGE OF SLAB PLAN, SEE A-111
 - FOR STRUCTURAL FRAMING PLAN, SEE S-101
 - FOR PLUMBING PLAN, SEE P-301
 - FOR FLOOR DRAIN LOCATIONS, SEE P-301
 - FOR SPRINKLER PLAN, SEE FP-301
 - FOR ELECTRICAL POWER PLAN, SEE E-101
 - FOR MECHANICAL PLAN, SEE M-301 & M-301P
 - FOR FIRE ALARM WORK, SEE E-301
 - FOR ELECTRICAL LIGHTING PLAN, SEE E-201
 - FOR SECURITY PLAN, SEE SEC-101
 - FOR AUDIOVISUAL WORK, SEE EAV-121 & AV-121
 - FOR SITE WORK, SEE C- AND BPP-SERIES DRAWINGS
 - FOR CONSTRUCTION LAYOUT GEOMETRY, SEE G-006
 - FOR GLASS & CURTAINWALL SCHEDULE, SEE A-505
 - FOR ARCHITECTURAL WOODWORK SCHEDULE, SEE A-506
 - FOR DECORATIVE METAL SCHEDULE, SEE A-506

- GENERAL NOTES**
- UNLESS OTHERWISE NOTED, FURNITURE AND EQUIPMENT IS NOT IN CONTRACT AND IS TO BE PROVIDED BY OWNER. FURNITURE IS INDICATED FOR REFERENCE ONLY.

LEGEND

	METAL FLAKE CERAMIC TILE
	CERAMIC TILE FLOORING

1 FIRST FLOOR PLAN
 A121 Scale: 1/4" = 1'-0"

